

# Why Build a New Municipal Building?

## *Why a new Town Hall?*

- Town Hall has a deteriorating foundation and persistent flooding and water leakage
- The well's corrosive water causes continued deterioration of piping and mechanical equipment.
- The building has NO drinkable water and is not energy efficient
- Due to the lack of climate control in the Town's vault, moisture has seeped in through exterior walls jeopardizing valuable and historic documents
- There is not enough parking for staff and the public
- The Town Hall has never been able to accommodate Social Services or Park & Rec costing taxpayers **\$52,000** annually in rent
- Taxpayers spent more than **\$91,000** in repairs and maintenance to Town Hall/PD in 2017



*The Town Hall, Police and Building departments.*

## *Why a new Police Department?*

- This winter septic waste from corroded pipes closed portions of the Finance Department and the Police Department until repairs and cleaned up were completed, forcing the Police Department to work from a mobile unit borrowed from the state.
- The Department lacks a compliant prisoner transport area and holding cells for women and juveniles
- There are no locker facilities for females officers limiting hiring ability and diversity
- A lack of adequate parking costs taxpayers **\$12,600** annually for off-site patrol car parking

## *Why include the Board of Education building?*



*Board of Education*

- It is not ADA compliant and would require the installation of an exterior elevator
- The 100-year-old building has no fire escape, no central air system, old windows, and is not energy efficient
- It's less expensive to add to the Municipal Building than retrofit the existing building.
- Taxpayers spend **\$22,000** annually to repair and maintain the structure

## *Why not the Village Center?*

- The cost estimate for renovating Center School and an addition for 4th and 5th grades is **\$44 million**
- Other Village Center properties (14 in total) were too small, environmentally unsafe or in a flood plain
- Of the eight new properties submitted & reviewed based on a strict criteria and in a public forum, Edgewater Hill ranked highest by six of the seven Town Council members.
- **The projected cost of a new Municipal Building is \$18.9 million.** The price of construction goes up an estimated **\$350,000** every year the project is delayed



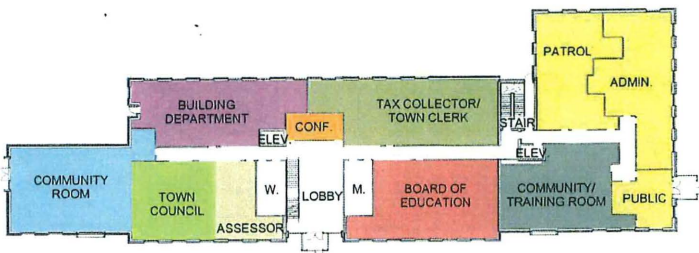

**The Main Floor:** lobby, Board of Education, Tax Collector, Tax Assessor, Town Clerk, Registrar of Voters, Building Department, Town Council chambers, Fire Marshal, multi-purpose Community Room, Emergency Operations Center and the Police Department.

The proposed East Hampton Municipal Building incorporates a cost-effective New England design with brick exterior and a peaked metal roofline over the center buildings. An efficient low slope metal roof covers the wings that house Police Department (right) and Community Room (left). The first level of the Police Department is below ground level ensuring privacy, a secure access and adequate parking, while the public entrance is visible on ground level to the right. Public entrance to Town Hall and Board of Education is located in the center of the building. Total square footage = 33,400.

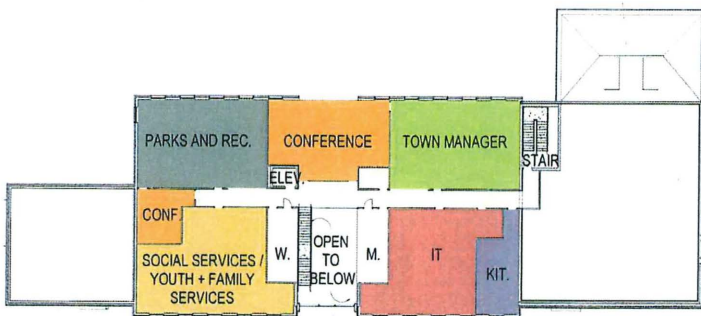

**The Second Floor:** Park & Rec, Town Manager's office, Social Services, Youth & Family, Finance Department and Information Technology as well as two conference rooms.

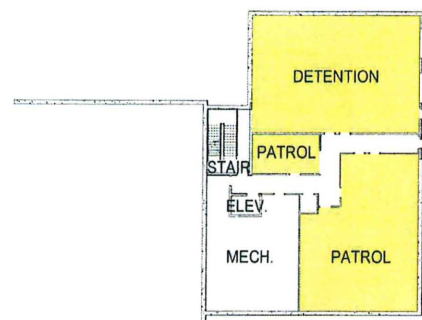

**The Lower Level of the Police Department:** secure entrance to criminal detention center, the patrol room and mechanical room.

**Join us for a Municipal Town Building Forum  
Tuesday Aug. 29 6:30 p.m. in the High School T-Bell Room**