

NOTE
 KITCHEN EXHAUST SYSTEM, MAKE-UP AIR
 WILL BE ADDED AT A LATER DATE.

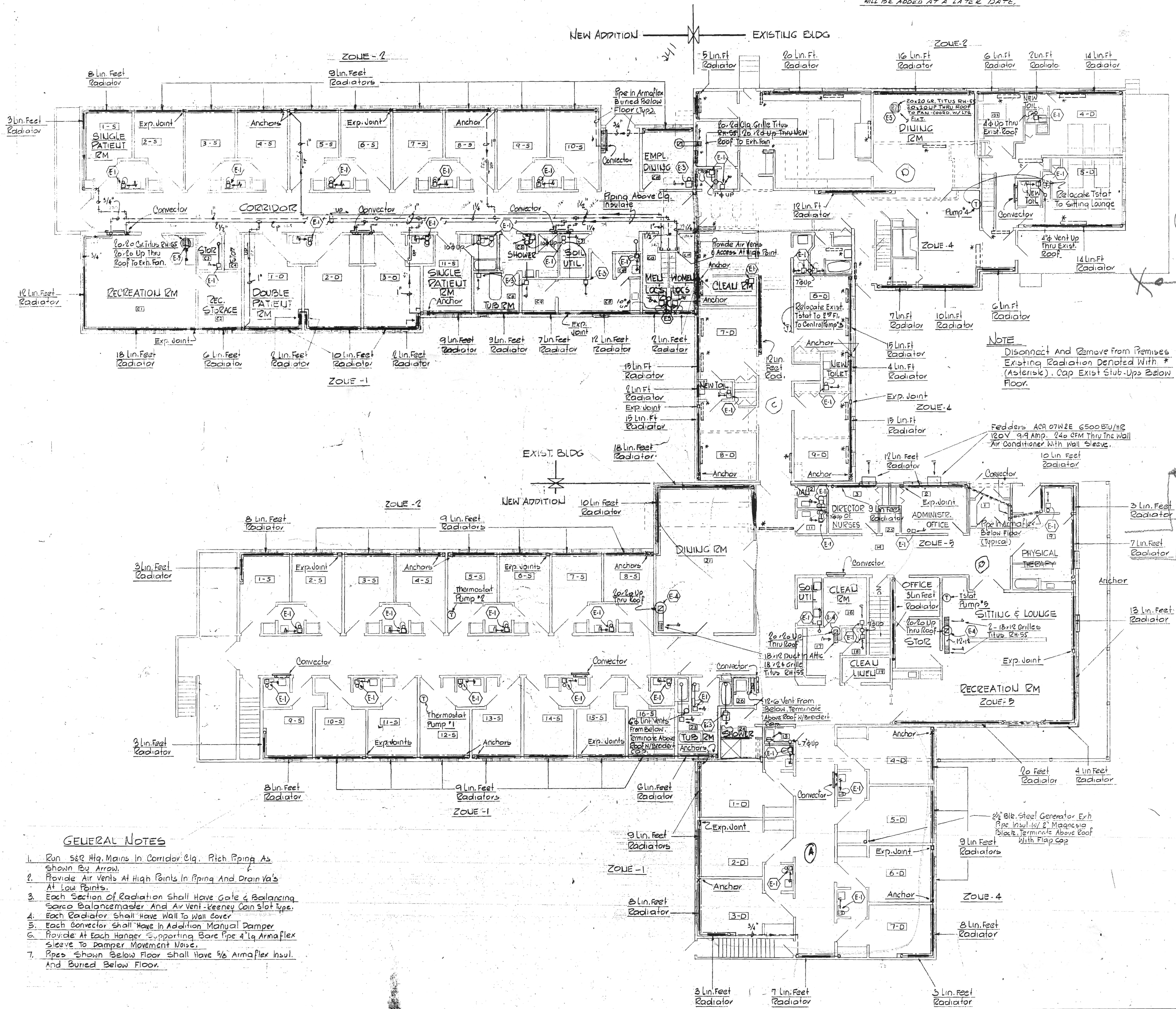

NOTE
 Disconnect And Remove from Premises
 Existing Radiation Denoted With *
 (Asterisk). Cap Exist. Stub-Ups Below
 Floor.

Feeders ACR 07W2E 6500B/H2
 120V 9.9 Amp. 240 CFM Thru The Wall
 Air Conditioner With Wall Sleeve.

GENERAL NOTES

1. Run S&R Hq. Mains In Corridor Clq. Pitch Piping As Shown By Arrow.
2. Provide Air Vents At High Points In Piping And Drain Y's At Low Points.
3. Each Section Of Radiation Shall Have Gate & Balancing Sarcos Balancemaster And Air Vent-Keeney Con Slot type.
4. Each Radiator Shall Have Wall To Wall Cover.
5. Each Convector Shall Have In Addition Manual Damper.
6. Provide At Each Hanger Supporting Bare Pipe 4" Iq Armaflex Sleeve To Damper Movement Noise.
7. Pipes Shown Below Floor Shall Have 5/8 Armaflex Insul. And Buried Below Floor.

HEATING AND VENTILATING - MAIN FLOOR PLAN
 SCALE: 1/8" = 1'-0"

HEATING FLOOR PLAN		DESIGN BY T. Z.
PROPOSED ADDITION TO THE COBALT LODGE COBALT COMM.		CHECKED BY A. V. S.
A. SULKOWSKI & ASSOCIATES GRAND PRIX BUILDING 824 HOLLAND STREET EAST HARTFORD, CONN. 06108 TEL. 528-7700		DATE 12-29-70
DWG. NO.		H-1