

SANITARY SYSTEM DESIGN

NUMBER OF BEDROOMS: 2
 PERCOLATION RATE: 2.5 MIN/IN
 ABSORPTION AREA REQUIRED: 2,000 SQ. FT. (MIN.)
 USE 2" V.P. OF SERVICE: 7.5 V.P. REQ'D
 USE 3" DRINKS AT: 7 V.P. EACH
 SEPTIC TANK CAPACITY: 1,250 GAL. (MIN.)
 USE 2" OR 4" HOLLOW DRINKS W/ 2" STONE
 PROVIDED: EFFECTIVE LEACHING AREA

TEST PIT # 3
 DATE: 5-10-84
 MATERIAL: 12" DIA. CONCRETE
 18" DIA. CONCRETE
 18" DIA. CONCRETE
 NO GROUND WATER
 PERK. HOLE # 3 5 MIN. IN.

NOTE: SEPTIC SYSTEM TO BE INSTALLED AS PER SPECIFICATIONS OF LOCAL DEPT. OF HEALTH SERVICES SURFACE SEWAGE DISPOSAL CODE AND TOWNSHIP OF EAST HAMPTON HEALTH DEPARTMENT REGULATIONS. BENCHMARK TO BE SET BY DESIGN ENGINEER AT TIME PROPOSED FOUNDATION IS STAKED.

SANITARY SYSTEM ELEVATIONS

	1	2	3
BOTTOM OF DRINKS	105.5	105.5	105.5
P.L. DISTRIBUTION LINE	106.5	106.5	106.5
DISTRIBUTION BOX INLET	106.5	106.5	106.5
SEPTIC TANK OUTLET	106.5	106.5	106.5
SEPTIC TANK INLET	106.5	106.5	106.5
P.L. W/ C.P. AT FND. WALL	106.5	106.5	106.5
BASEMENT FLOOR	105.5	105.5	105.5
TOP OF SEPTIC TANK	105.5	105.5	105.5

INDICATES REVERSE DISTRIBUTION BOX

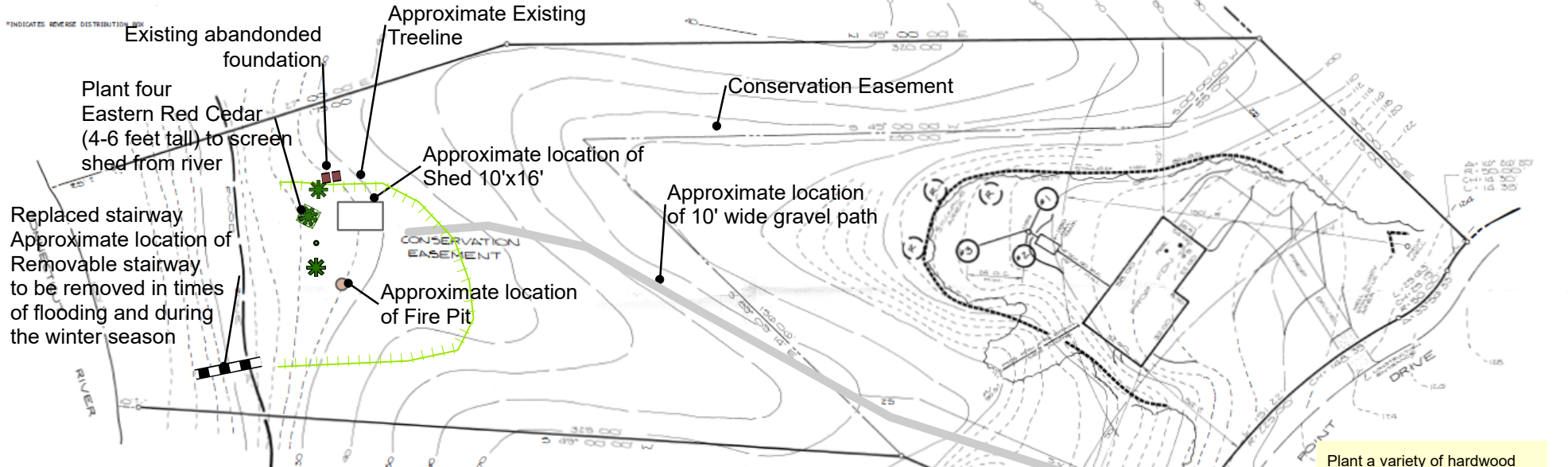

TOPOGRAPHY BASED ON THE FOLLOWING INFORMATION:
 EXISTING CONTOURS ON 8" OF SERVICE SUBDIVISION MAP
 PROPOSED CONTOURS ON REFERENCED SUBDIVISION MAPS

NOTE: LOT MAY BE SUBJECT TO A CLIP EASEMENT

LOT LINES TAKEN FROM MAP TITLED "SUBDIVISION PLANS HIGH POINT ESTATES & ASSOCIATES C.E. & L.S. GASTON/BLANK CO. DATE: 11-2-83 REL. 3-10-83 SCALE: 1"=60' MAP NO. 12-83-1 SHEET 4 OF 11 SHEETS

NO ZONING VIOLATIONS
 I HEREBY DECLARE THAT THIS MAP IS SUBSTANTIALLY CORRECT.
 THIS MAP AND SURVEY WERE PREPARED IN ACCORDANCE WITH THE STANDARDS OF A CLASS-A SURVEY AS DEFINED IN THE RECOMMENDED STANDARDS FOR SURVEYS AND MAPS IN THE STATE OF CONNECTICUT AS PREPARED AND ADOPTED BY THE CONNECTICUT ASSOCIATION OF LAND SURVEYORS, INC. ON SEPTEMBER 24, 1982

Also provide and plant four highbush blueberry: (Among the top shrubs for pollinators and songbirds, is indigenous to Connecticut. Its flowers attract several native specialist bees. Native bumble bees vibrate their wings, a technique known as buzz pollination, to extract pollen.)

David and Melissa Baribault Application to permit a shed under 200 sq ft within the Conservation Easement and replace stairs leading to the River with temporary stair that are removable during the winter season



Information is approximate and not to scale
 Information added to this plan not prepared by licensed surveyor. Refer to attached Planting Schedule

Plant a variety of hardwood trees (Total 6 trees) in locations where trees were removed, as follows: Red oak, White oak, Black birch and Red Maple
 Trees will be 4-6 feet tall.
 Refer to Planting Schedule

PLEASE NOTE: THE BUILDING OWNER IS RESPONSIBLE FOR ALL EROSION CONTROL AND STABILIZATION REQUIREMENTS. PLEASE REVIEW THE APPROVED LOT PLAN FOR EROSION CONTROL REQUIREMENTS.

PLEASE NOTE: THE BUILDING OWNER IS RESPONSIBLE FOR ALL CONDITIONS OF SUBDIVISION APPROVAL RELATING TO THIS LOT. PLEASE REVIEW THE APPROVED SUBDIVISION ON FILE IN THE TOWN CLERK'S OFFICE AS TO BE AWARE OF ALL CONDITIONS OF APPROVAL.

PLEASE NOTE: THE BUILDING OWNER IS RESPONSIBLE FOR ALL CONDITIONS OF SUBDIVISION APPROVAL RELATING TO THIS LOT. PLEASE REVIEW THE APPROVED SUBDIVISION ON FILE IN THE TOWN CLERK'S OFFICE AS TO BE AWARE OF ALL CONDITIONS OF APPROVAL.

NOTE: UNDERGROUND UTILITY LOCATIONS APPROXIMATE ONLY. VERIFY ALL LOCATIONS IN THE FIELD BEFORE START OF CONSTRUCTION. (SEE NOTE BELOW)

WARNING: THESE PLANS NOT TO BE USED FOR LOCATION OF UNDERGROUND UTILITIES - CALL BEFORE YOU DIG 1-800-955-8877 WORKING DAYS BEFORE YOU DIG

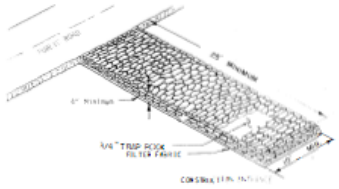

LOT 8 HIGH POINT DRIVE	
PREPARED FOR	
DAVID BARIBAULT	
EAST HAMPTON, CONN.	
DRAWN BY: S.A.M.	MEGSON & HEAGLE CIVIL ENGINEERS & LAND SURVEYORS EAST HAMPTON, CONN.
CHECKED BY: DATE: 4-19-84	SCALE: 1" = 20' MAP NO. 71-24-1