

RAIN Garden

LAKE Side

- ② Add gutters + Drain Pipe to Rain gardens
- ① Add 6 (4x4) posts to these areas of the deck with concrete piers

RAIN Garden

Install Dry Space ceiling in this section (13' x 15') and add gutters and drain pipes to Rain gardens on outside of extended deck.

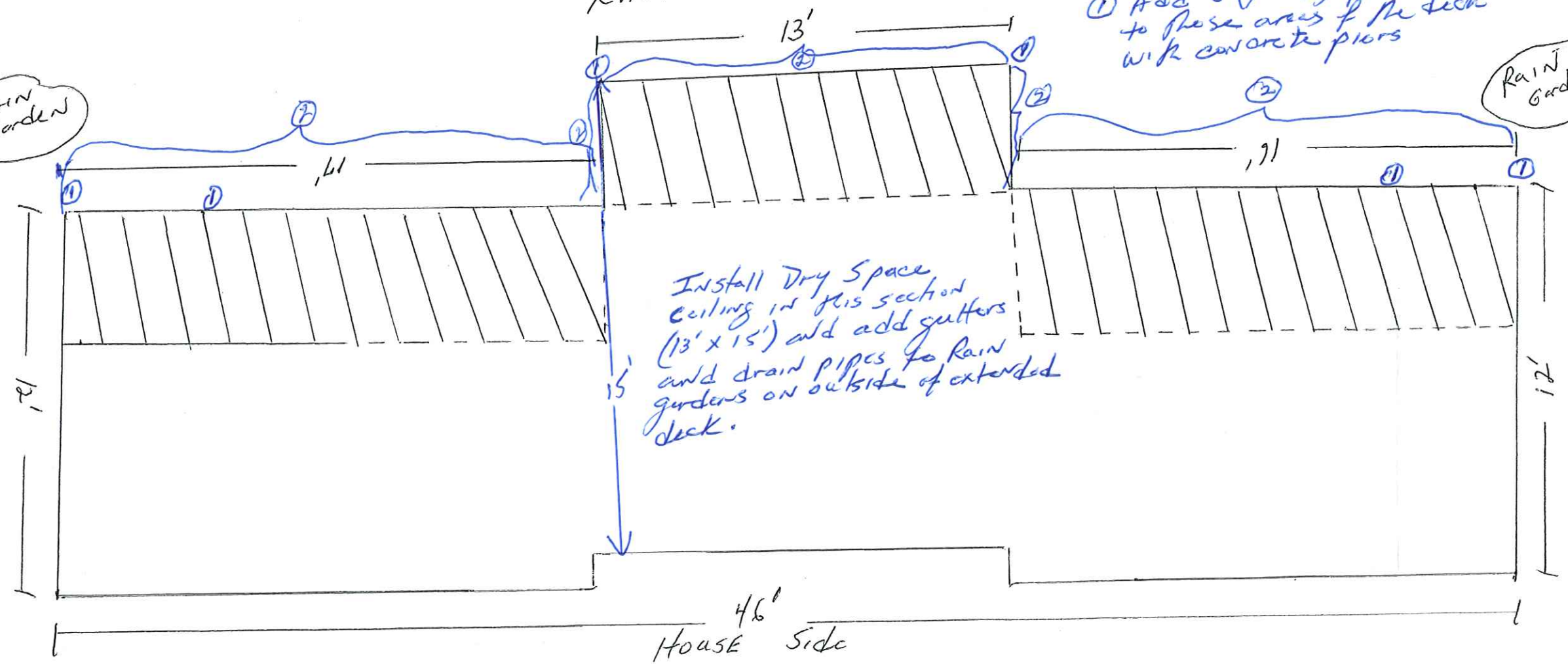

Scale 1/4" = 1ft

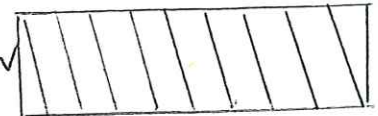
Deck Addition  46' x 4' = 184 sqft