

DESIGN TABLE:
 MODULE MODEL - 370W TSM-DE14A (II)
 PROP. TILT - 20 DEGREES
 INTER-ROW SPACING - 13 FEET
 DC OUTPUT - 2.59 MW
 TOTAL NUMBER OF MODULES - 6,994 MODULES



55 GREENS FARMS ROAD
 WESTPORT, CT 06880
 OFFICE: (203)-557-5554



3 SADDLEBROOK DRIVE PHONE: (860)-653-1697
 KILLINGWORTH, CT 06419 FAX: (860)-653-0935
 WWW.ALLPOINTSTECH.COM

CONCEPT

NO	DATE	REVISION
0	11/20/19	FOR REVIEW: BJP
1	01/16/20	REVISED LAYOUT: BJP
2	01/21/20	REVISED LAYOUT: BJP
3	02/06/20	REVISED LAYOUT: BJP
4		
5		
6		

DESIGN PROFESSIONAL OF RECORD

PROF: BRADLEY J. PARSONS P.E.
 COMP: ALL-POINTS TECHNOLOGY CORPORATION
 ADD: 3 SADDLEBROOK DRIVE
 KILLINGWORTH, CT 06419

OWNER: SKINNER STREET PROPERTIES LLC
 ADDRESS: 9 SEQUONIA TRAIL
 EAST HAMPTON, CT 06424

EAST HAMPTON INDUSTRIAL PARK GROUND MOUNT

SITE: 46 SKINNER STREET
 ADDRESS: EAST HAMPTON, CT 06424

APT FILING NUMBER: CT667110

DRAWN BY: CSH

DATE: 11/20/19 CHECKED BY: BJP

SHEET TITLE:

CONCEPT PLAN

SHEET NUMBER:

CP-1

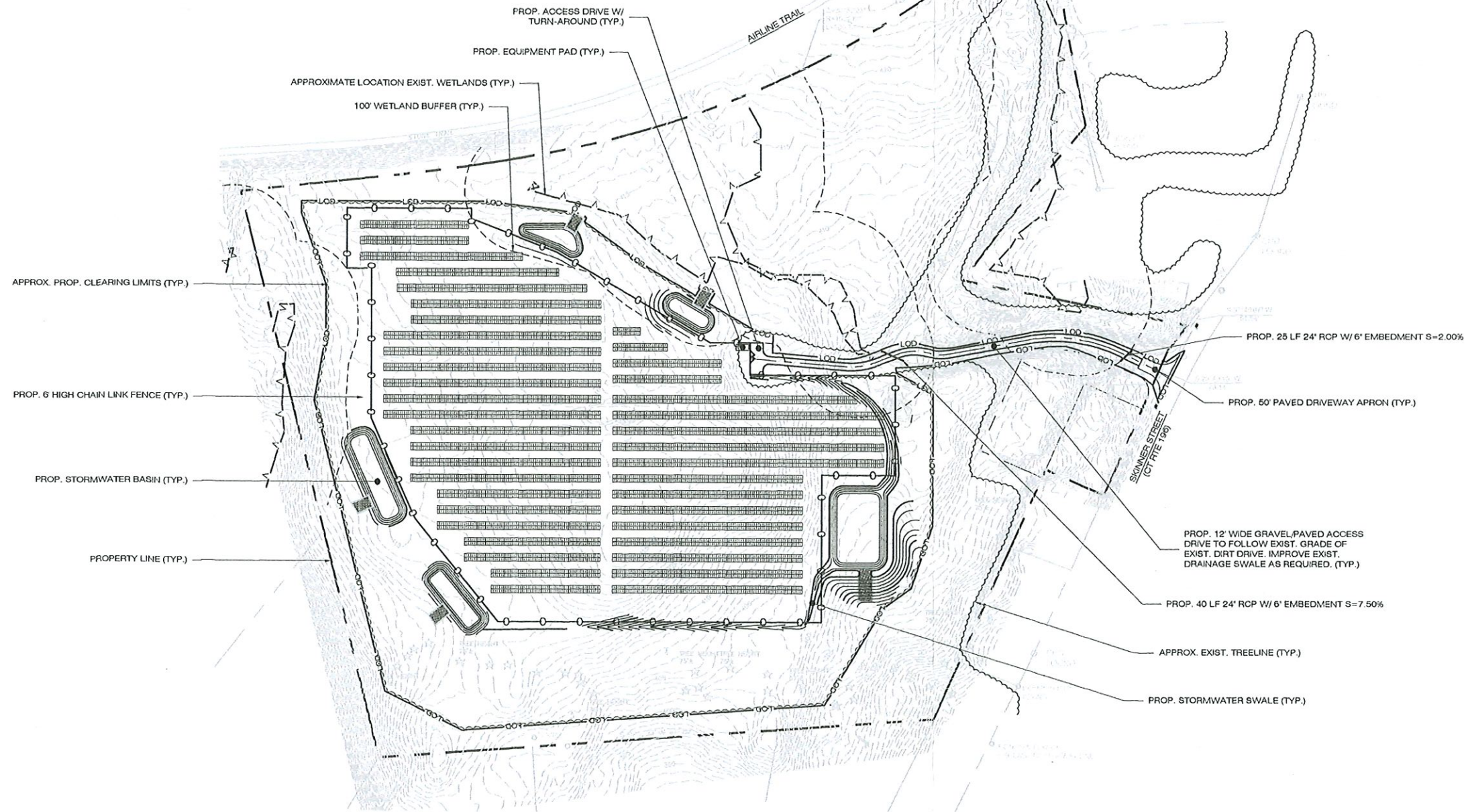

1 CONCEPT PLAN
 CP-1 SCALE: 1" = 100'-0"

