

EAST HAMPTON CONSERVATION-LAKE COMMISSION
860-267-4468

APPLICATION REVIEW

Meetings are held on the 2nd Thursday of the month per the attached schedule.

PROPERTY LOCATION: _____

PROJECT NAME: _____

APPLICANT: _____ **DAYTIME PHONE:** _____

MAILING ADDRESS: _____

OWNER IF DIFFERENT: _____

MAILING ADDRESS: _____

ACTIVITY: P&Z Application: _____

IWWA Application: _____

ZBA Application: _____

REVIEW DATE: _____

COMMENTS: _____

Office Use Only

Fee Paid \$135.00
Public Hearing: YES NO

Date Approved _____
Agent Approval: YES NO

Permit Number TW-20-026

RECEIVED
SEP 29 2020

TOWN OF EAST HAMPTON
INLAND WETLANDS & WATERCOURSES AGENCY

Date: Sept. 28, 2020

1. Name of Applicant* Steven Phillips

TIME _____
steve.7703@hotmail.com

Phone Numbers: Home _____, Business _____, Cell 860-221-5599

Home Address: Street 16 Maplewood Drive Town East Hampton State/Zip CT / 06424

Business Address: Street _____ Town _____ State/Zip _____

* All applications MUST list contact phone numbers. If the applicant is a Limited Liability Corporation or a Corporation, provide the managing member's or responsible corporate officer's name, address, and telephone number.

2. Name of Property Owner (if different from Applicant): _____ Phone _____

Address: Street _____ Town _____ State/Zip _____

As the legal owner of the property listed on this application I hereby consent to the proposed activities. I hereby authorize the members and agents of the Agency to inspect the subject land, at reasonable times, during the pendency of the application and for the life of the permit.

Printed Name: Steven Phillips, Signature: [Signature], Date: 9-28-2020

3. Provide the applicant's interest in the land. _____

4. Site Location and Description: Assessor's Map 19, Block 39A, Lot 10A-4

Address: Street 16 Maplewood Drive Town East Hampton State/Zip CT / 06424

Note: It is the applicant's responsibility to provide the correct site address, map, block, and lot number for the legal notice.

Provide a description of the land in sufficient detail to allow identification of the inland wetlands and watercourses, the area(s) (in acres or square feet) of wetlands or watercourses to be disturbed, soil type(s), and wetland vegetation.

Area of Wetland to be disturbed: _____ acres or sq. ft.

Area of Watercourse to be disturbed: _____ acres or sq. ft.

Area of Upland Review Area to be disturbed: 512 sq. ft. acres or sq. ft. (Area within 100' of wetland)

TOTAL AREA OF DISTURBANCE

512 sq. ft. acres or sq. ft.

Will fill be needed on site? Yes No If yes, how much fill is needed? _____ cubic yards

The property contains (circle one or more)

WETLANDS, BROOK, RIVER, INTERMITTANT STREAM, VERNAL POOL, SWAMP, OTHER _____

Description of soil types on site: _____

Description of wetland vegetation: _____

Name of Soil Scientist and date of survey: _____

5. Attach a written narrative of the purpose and description of the proposed activity and proposed erosion and sedimentation controls, best management practices, and mitigation measures which may be considered as a condition of issuing a permit for the proposed regulated activity including but not limited to; measures to:

(1) prevent or minimize pollution or other environmental damage, (2) maintain or enhance existing environmental quality, or (3) in the following order of priority: restore, enhance or create productive wetland or watercourse resources. Depending on the complexity of the project, include the following: sequence of operations, drainage computations with pre and post construction runoff quantities and runoff rates, plans clearly showing the drainage areas corresponding to the drainage computations, existing wetland inventory and functional assessment, soils report, construction plans signed by a certified soils scientist, licensed surveyor, and licensed professional engineer. Include a construction schedule, impacts to vegetation, and pictures that clearly show the existing conditions of all areas to be disturbed and/or cleared of vegetation.

6. Provide information of all alternatives considered. List all alternatives which would cause less or no environmental impact to wetlands or watercourses and state why the alternative as set forth in the application was chosen. All such alternatives shall be diagramed on a site plan or drawing.

Attach plans showing all alternatives considered.

7. Attach a site plan showing the proposed activity and existing and proposed conditions in relation to wetlands and watercourses and identifying any further activities associated with, or reasonably related to, the proposed regulated activity which are made inevitable by the proposed regulated activity and which may have an impact on wetlands or watercourses. Include a colored grading plan showing areas to be filled (green) and areas to be excavated (brown) that clearly shows existing and proposed contours and proposed limits of disturbance.

8. Attach the names and mailing addresses of adjacent landowners. Attach additional sheets if necessary.

Name Michelle LaFar Address 20 Maplewood Drive

Name John and Mary Decoursey Address 12 Maplewood Drive

Name _____ Address _____

9. Attach a completed DEEP reporting form.

The Agency shall revise or correct the information provided by the applicant and submit the form to the Commissioner of Environmental Protection in accordance with section 22a-39-14 of the Regulations of Connecticut State Agencies.

10. Attach the appropriate filing fee based on the fee schedule in Section 19 of the regulations.

Fee: _____ (Make check payable to "The Town of East Hampton")

11. Name of Erosion Control Agent (Person Responsible for Compliance): Mike

Phone Numbers: Home _____, Business 860-872-8797

Cell 860-966-2809 Address: Street 34 West Rd. Town Ellington

State/Zip CT 06029

12. Are you aware of any wetland violations (past or present) on this property? YES ☐ NO ☒

If yes, explain _____

13. Are you aware of any vernal pools located on or adjacent (within 500') to the property? YES ☐ NO ☒

14. For projects that do not fall under the ACOE Category 1 general permit – Have you contacted the Army Corps of Engineers? YES ☐ NO ☒

15. Is this project within a public water supply aquifer protection area or a public water supply watershed area? YES ☐ NO ☒

If so, have you notified the Commissioner of the Connecticut Department of Public Health and the East Hampton WPCA? YES ☐ NO ☒

(Proof of notification must be submitted with your application.)

16. PUBLIC HEARINGS ONLY. The applicant must provide proof of mailing notices to the abutters prior to the hearing date.

17. **As the applicant I am familiar with all the information provided in the application and I am aware of the penalties for obtaining a permit through deception or through inaccurate or misleading information.**

Printed name: Steven Phillips, Signature: [Signature], Date: 9-28-2020

Please Note: You or a representative must attend the Inland Wetlands meeting to present your application.

To Whom It May Concern,

My wife and I are submitting a request to the Town Inland Wetlands and Watercourses Agency to seek approval from the Town to install a 16'x32' in ground pool in the location where we currently have a 15'x30' above ground pool.

The installer for the in ground pool will be excavating at the site of the new pool while leveraging silt fencing as well as hay bales, if needed, to prevent any run off from entering the wetlands as well as ensuring the area, soil, and any sediment are contained. All of the soil excavated will be removed by the installer and disposed of by the installer.

Attached are pictures taken today of the wetland area that is located to the rear and left of the proposed new pool.

The proposed date of installation will take place in the late spring/summer and is tentatively scheduled for June of 2021. I have also attached photo's of the wetlands in question.

Please reach out to me if there are any questions/concerns. We are seeking to have this completed as soon as possible so the installer can schedule the install. I can be reached at (860) 221-5599.

Sincerely,



Steven Phillips
16 Maplewood Drive
East Hampton, CT 06424

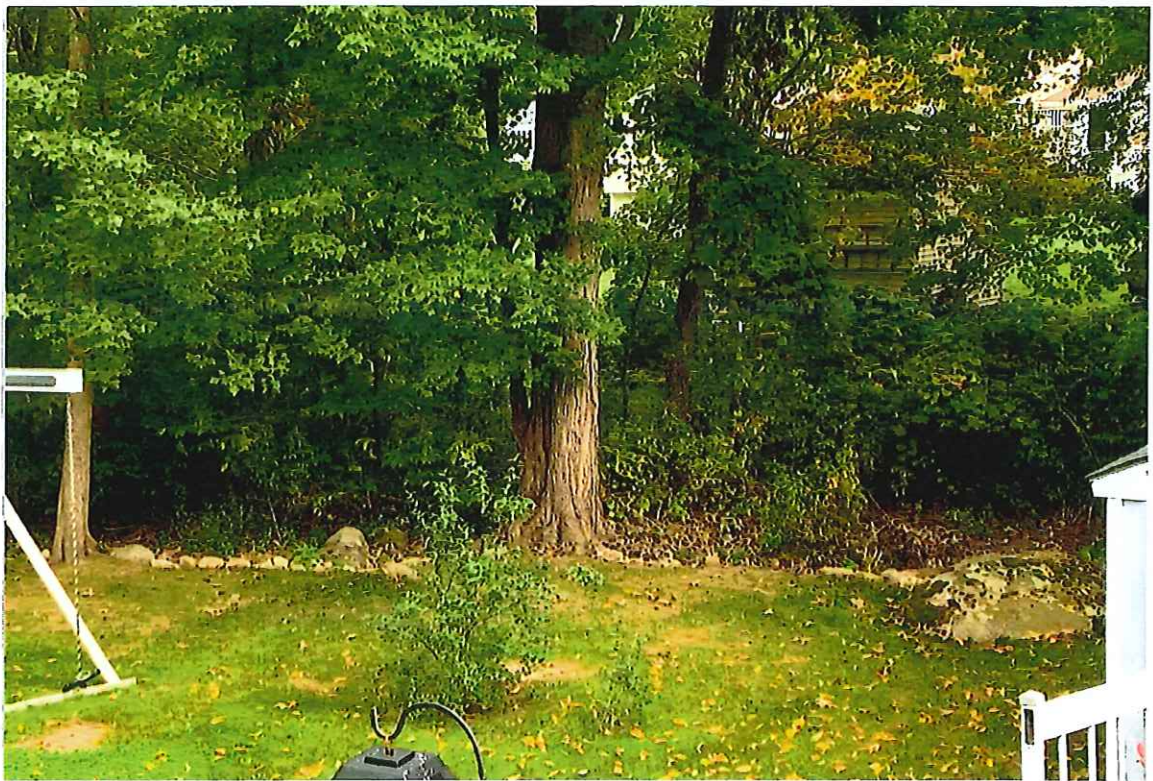
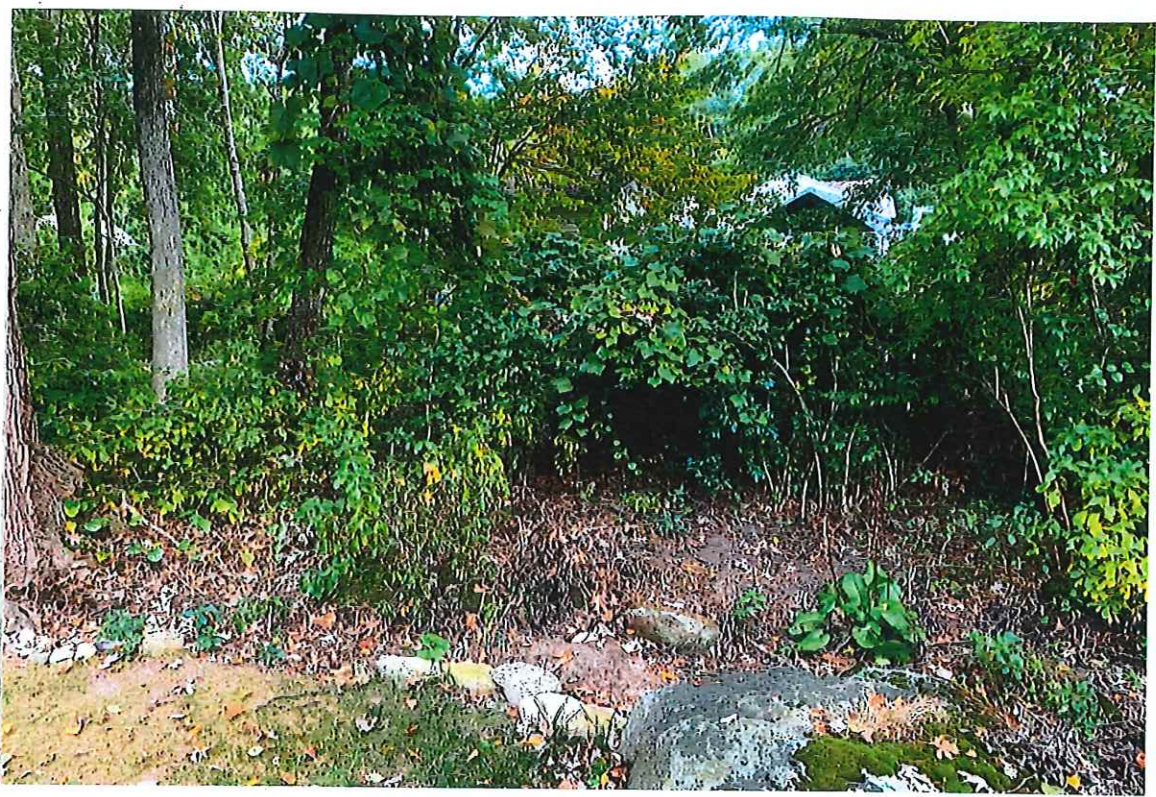
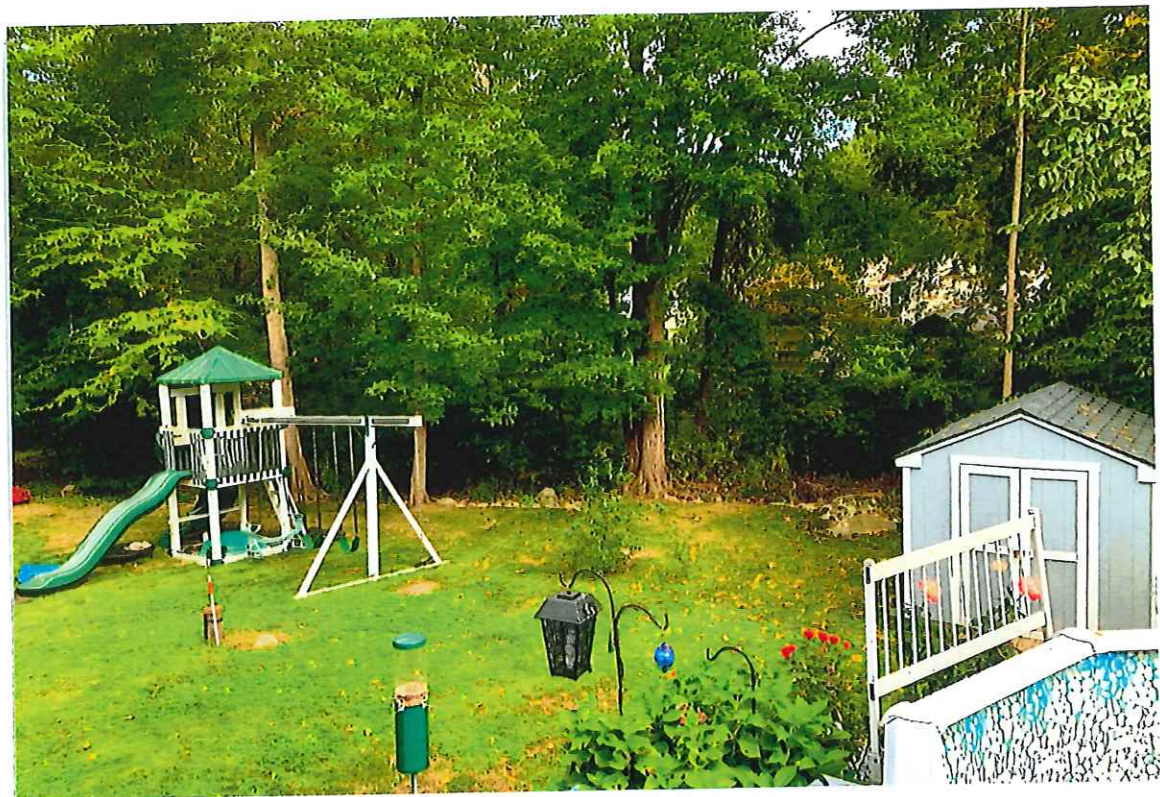

N/F DCC215 CCELIK

709

VETLADS

17' 5" 148.93
17' 5" 17° 15' 54" E
20' WIDE - SANITARY SEWER EASEMENT

LOT No. 5
NORTH MAPLE GROVE SUBDIVISION

AREA= 26.147 S.F.
LOT 10.2 AC.

LOT No. 5

5 SUBDIVISION

2 50.00
4 8.49.56
6 7.70

41.69
59" 50" 15"

128.07.

三
二
一
〇
九
八

W
a
n
n

[illegible]

217

CL 66 V. 2 H 70

CE2TIFIED 6U83T4J74LLP C02P2ECT

I HEREBY CERTIFY THAT THIS MAP AND SURVEY WERE PREPARED IN ACCORDANCE WITH THE STANDARDS OF A CLASS A-2 SURVEY AS DEFINED IN THE CODE OF PRACTICE FOR STANDARDS OF ACCURACY OF SURVEYS AND MAPS, ADOPTED DECEMBER 10, 1975 AS AMENDED BY THE CONNECTICUT ASSOCIATION OF LAND SURVEYORS, INC.



Charles D. Jones